

Starck 3 Toilet seat and cover # 0063890000

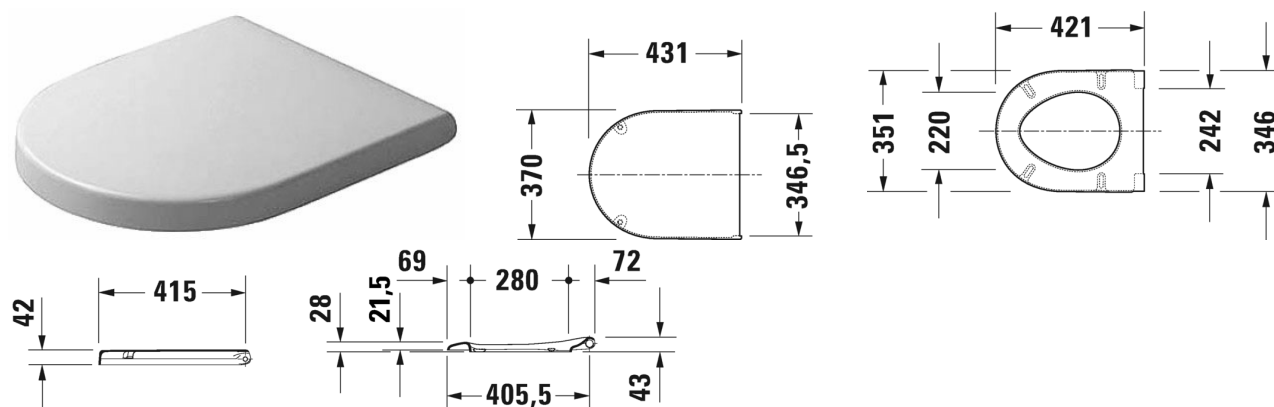

| Toilet seat and cover | Dimension | Weight | Order number |
|---|--------------|----------------|--------------|
| hinges stainless steel, removable, with soft closure | | | |
| Colors | | | |
| 00 White Alpin | | | |
| Variant | | | |
| | | 2.100 kilogram | 0063890000 |
| Suitable products | | | |
| Toilet close-coupled washdown model, (without cistern), fixings included, vertical outlet, UWL class 2, 360 x 655 mm | 360 x 655 mm | | 012601 |
| Toilet close-coupled washdown model, (without cistern), fixings included, horizontal outlet, 360 x 655 mm | 360 x 655 mm | | 012609 |
| Toilet close-coupled (without cistern), washdown model, fixings included, 360 x 655 mm | 360 x 655 mm | | 012809 |
| Toilet floor standing for independent water supply, washdown model, fixings included, horizontal outlet, UWL class 2, 6,0 l, 360 x 560 mm | 360 x 560 mm | | 012409 |
| Toilet wall mounted washdown model, UWL class 1, 360 x 540 mm | 360 x 540 mm | | 220009 |
| Toilet wall mounted washout model, UWL class 2, 360 x 540 mm | 360 x 540 mm | | 220109 |
| Toilet wall mounted Compact washdown model, UWL class 2, 360 x 480 mm | 360 x 480 mm | | 220209 |
| Toilet wall mounted Comfort washdown model, seat height + 50 mm, UWL class 2, 360 x 545 mm | 360 x 545 mm | | 221509 |
| Toilet wall mounted Fixation clearance 230 mm, washdown model, UWL class 2, 360 x 540 mm | 360 x 540 mm | | 220609 |

Starck 3 Toilet seat and cover # 0063890000

| | | |
|---|--------------|--------|
| Toilet wall mounted washdown model, Durafix included, UWL class 1, 360 x 540 mm | 360 x 540 mm | 222509 |
| Toilet wall mounted Compact washdown model, Durafix included, UWL class 1, 360 x 485 mm | 360 x 485 mm | 222709 |
| Toilet wall mounted Duravit Rimless® rimless, washdown model, Durafix included, UWL class 1, 360 x 540 mm | 360 x 540 mm | 252709 |
| Toilet wall mounted SASO-version, washdown model, Durafix included, 4,0 l, 360 x 540 mm | 360 x 540 mm | 252609 |
| | | |

All drawings contain the necessary measurements which are subject to standard tolerances. They are stated in mm and are non-binding. Exact measurements, in particular for customised installation scenarios, can only be taken from the finished piece.