

TECHNICAL DATA SHEET

PRODUCT

OFFSET QUAD WHITE – 45MM HIGH TRAYS (Length x Width, mm)

900x760 LH+RH Q, 900x800 LH+RH Q, 1000x800 LH+RH Q
1200x800 LH+RH Q, 1200x900 LH+RH Q

PRODUCT CODE

H976LQ100, H976RQ100, H980LQ100, H980RQ100
H1080LQ100, H1080RQ100, H1280LQ100, H1280RQ100,
H1290LQ100, H1290RQ100

PRODUCT VIEW



Shown with
optional panel kit

SPECIFICATION

- **FINISH :** ABS CAPPED ACRYLIC
 - **PRODUCT TYPE :** SANITARY WARE
 - **CONSTRUCTION :** STONE RESIN
 - **OUTLET DIAMETER :** 90mm
 - **OUTLET FLANGE DIAMETER:** 110 - 120mm
 - **PRODUCT HEIGHT :** 45mm (140mm ON RISER KIT)
 - **GUARANTEE PERIOD :** 12 MONTHS
 - **FITTING :** INSTRUCTIONS INCLUDED WITH PRODUCT
 - **OPTIONAL PANEL KIT:** HP1290Q100
-
- **DIMENSIONS FOR FITTING**

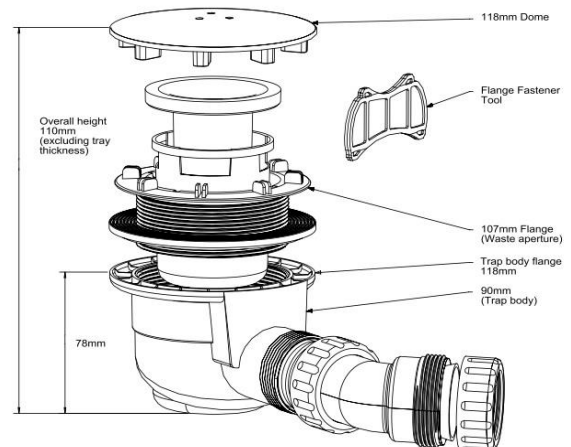
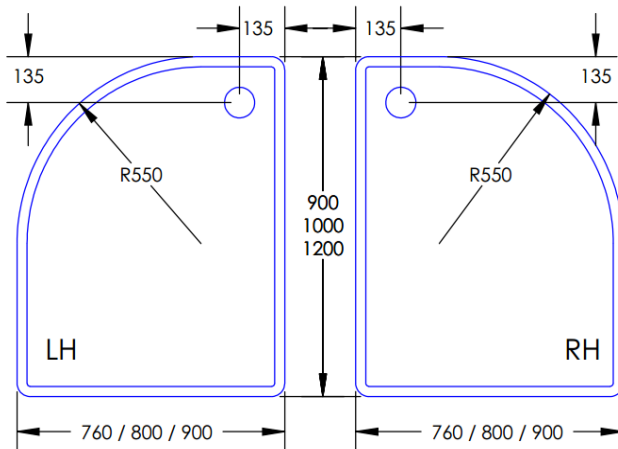

WASTE TRAP INCLUDED

- **FINISH :** ABS, POLYPROPYLENE, PVC SEALS, STEEL
- **FLOW RATE :** 48 LITRES / MIN
- **OUTLET :** 40mm PIPE WORK (1 1/2" - BS 522 UK PIPE SIZE)
- **STANDARDS :** BS EN 274-1 : 2002
- **CLEANABILITY :** TOP ACCESS CAPABLE FOR EASY CLEANING

