

Shelbourne Basin Mixer Tap



SPECIFICATION

Code	U39784
Style	Contemporary
Product Type	Bathroom Taps
Finish	Chrome
Main Construction Material	Brass
Inlet Connections	1/2"
Number of Tap Holes	1
Cartridge Type	35mm Ceramic Cartridge
Supply	Suitable for all Plumbing Systems
Working Pressure Range	0.2-5bar

COMPLIANCE APPROVALS

BA Standards

BS EN1286 & BS EN817

Wras Approved

Yes

Guarantee

5 Year Guarantee

*5 Year Guarantee on Taps and Showers applies to chrome finishes and main body of products.

*All taps and showers must be cleaned with warm soapy water and soft cloths only. The use of abrasive cleaners or materials will render warranty invalid.

*Flexible tail connections; thermostatic cartridges; hoses and handsets are covered by a 2 year guarantee.

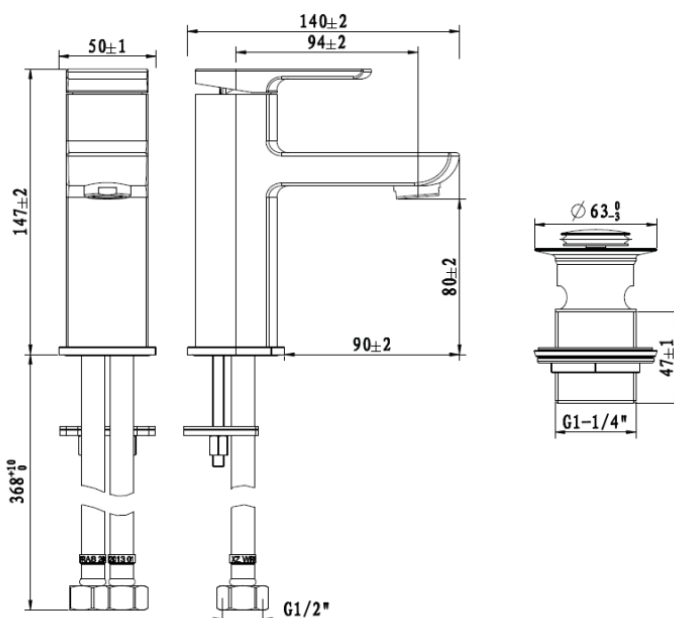

Flow rate

Pressure (Bar)	Full hot water (L/Min)	Full cold water (L/Min)	Mixed water (L/Min) Main water outlet
0.1	1.7	1.9	2.7
0.3	4.2	4.5	6.2
0.5	5.6	6.1	8.4
1.0	8.1	8.8	12
3.0	14.3	15.5	20.9
5.0	18.6	20	27